

SOUTH

OPEN BACK HALLWAY

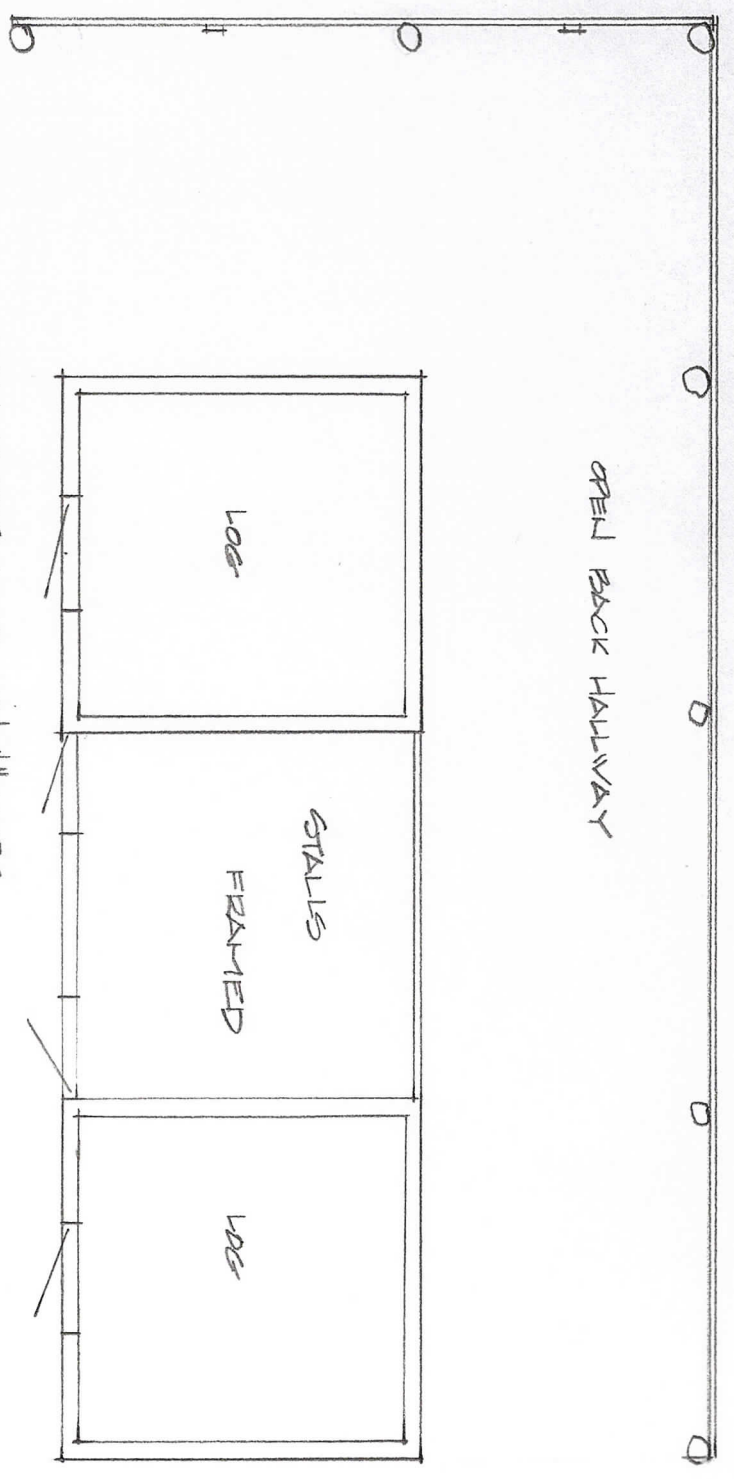

STALL DOORS AVE. 3'-4" WIDE

MAIN HALLWAY

WEST

LOG WIDTHS: 10" TO 17 1/2"  
 LOG THICKNESS: 4 1/2" TO 5" HEWN  
 SILLS: HEWN 8" X 8"

OPEN

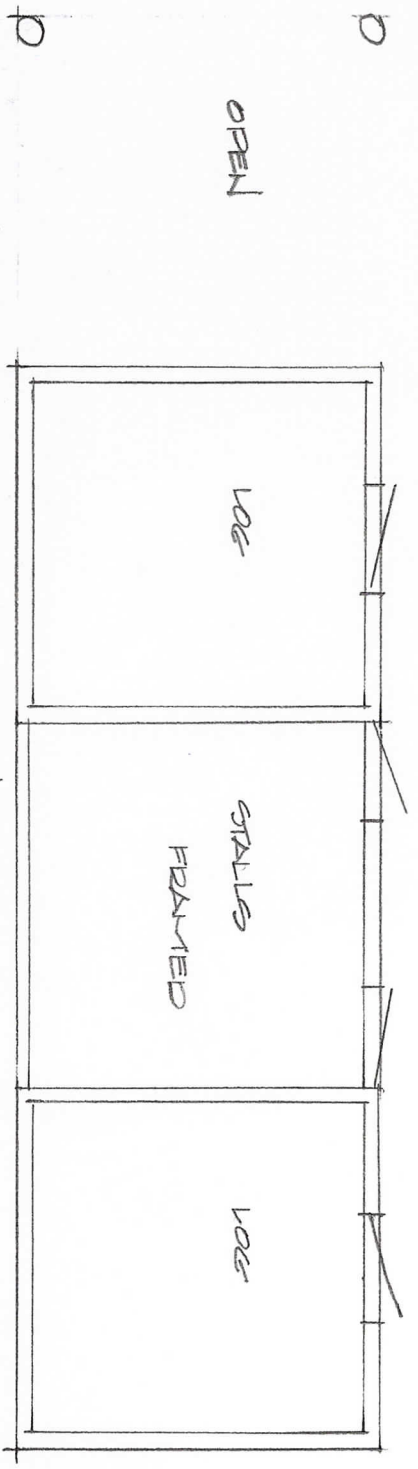

FLOOR PLAN SCALE 3/16" = 1'-0"

NORTH